

Public Document Pack

Witney Town Council

Mrs Sharon Groth FSLCC fCMgr
Town Clerk

Cllr Duncan Enright
Mayor of Witney



Town Hall, Market Square
Witney, Oxon
OX28 6AG
Tel: 01993 704379
Fax: 01993 771893
E-mail: info@witney-tc.gov.uk
www.witney-tc.gov.uk

07 January 2020

To: Members of the Witney Traffic Advisory Committee

You are hereby summonsed to a Meeting of the **Witney Traffic Advisory Committee** to be held in the Meeting Room - Bur Hall on **Tuesday, 14th January, 2020 at 2.30 pm** for the transaction of the business stated below.

AGENDA

All Council Meetings are open to the public and press, unless otherwise stated.

1. **Apologies for Absence**

To receive and consider apologies for absence.

2. **Public Participation**

3. **Minutes** (Pages 3 - 8)

- a) To adopt and sign as a correct record the minutes of the meeting held on 24 September 2019
- b) Matters arising from the minutes.

4. **Action Plan** (Pages 9 - 10)

To review the current action plan

5. **Review of the Committee Constitution, Terms of Reference and Frequency of Meetings** (Pages 11 - 14)

To review the Committee Constitution and Terms of Reference – and consider a request from the Volunteer Link-Up to be represented.

6. **CONSULTATION – A415 Ducklington Lane (Witney) - Proposed 30mph Speed Limit extension and Prohibition of Vehicles** (Pages 15 - 30)

To receive and consider a consultation from Oxfordshire County Council

7. **Climate Emergency**

This is a standing item on the agenda to discuss how the Committee might support the Town Council, which has declared a Climate Emergency.

8. **Update on Corn Street Road Safety**

To receive and consider a verbal update from the Chair.

9. **Update on Crossing for Station Lane**

To receive and consider a verbal report from the Chair – and any representations from residents.

10. **Update from OCC Localities Committee** (Pages 31 - 34)

To receive and consider correspondence from OCC's Localities Committee

11. **Report of the Principle Officer - Traffic Schemes Area Operations (North) - Oxfordshire County Council**

To receive and consider the report of the Principal Officer – Traffic Schemes Area Operations (North) – to follow

12. **Items Submitted to the Town Clerk** (Pages 35 - 38)

- Letter from North Leigh Resident Concerning Welch Way

13. **Items raised by members at the meeting**

14. **Forward Plan - future business**

To consider future items for consideration – per minute 727 – 24 September 2019.

15. **Date of Next Meeting**

The next meeting is scheduled to be held on 17 March 2020.

To agree dates of future meetings, suggested as:

- 2 June 2020,
- 22 September 2020,
- 12 January 2021



Town Clerk

**WITNEY TRAFFIC ADVISORY COMMITTEE MEETING OF THE
WITNEY TOWN COUNCIL**

Held on Tuesday, 24 September 2019

At 2.30 pm in the Meeting Room, Burwell Hall, Witney

Present:

Councillor L Price (Chair)

Councillors:	J King L Ashbourne (In place of J Aitman)	V Gwatkin
Other Members:	A Coles	West Oxfordshire District Council
Officers:	Mike Wasley Nicky Cayley Sharon Groth	Oxfordshire County Council Officer Democratic Services Officer Town Clerk
Others:	0 members of the public. John Croxton, Thames Valley Police Kevin Hickman, Windrush Bike Project Andrew Lyon, West Oxfordshire Community Transport	

718 **ELECTION OF CHAIRMAN**

Cllr Laura Price was elected Chairman of the Committee for the term lasting until September 2020.

719 **APOLOGIES FOR ABSENCE**

Apologies for their absence were received from Cllrs Aitman, Bartington, Morris and Fenton and Mrs Maria Wheatley (Parking Manager – WODC).

720 **PUBLIC PARTICIPATION**

There were no members of the public present at the meeting for this item.

The Chair reported that she had had an e-mail regarding speeding on Tower Hill.

721 **MINUTES**

a) **Minutes**

The minutes of the meeting held on 4 June 2019 were agreed as a correct record and signed by the Chair.

b) Matters Arising

Page 2 : T711 – The Chair thanked Mike Wasley for the County Council’s work on white lining throughout the town.

Page 3: T716 – The Chair advised that there were plans to address the late-night activity at the Leys through Youth Work and also via CCTV. She asked where things had got to in terms of a price for road humps. Mike Wasley replied that there would need to be a consultation and the costs estimate was around £10,000. Funding this would be tricky. The Town Clerk advised that she had had a meeting with the Community Safety Partnership and the Police who had done a safety audit. Speed bumps had been identified as something that might help and there may be some funding. The Chair asked if Mike Wasley could put this into writing and send it to the Town Clerk. She thought it could then go with a report to a Town Council meeting. A consultation could be done if this was something to be pursued. Kevin Hickman expressed concern that speed humps were not cycle/trike friendly and the Chair advised him to contact the Town Council’s cycling champion, Cllr Smith, to discuss view on this.

722 **ACTION PLAN**

The Committee received and considered the action plan from the last meeting and revised this where required. This is attached to the minutes.

723 **NATIONAL HIGHWAY AND TRANSPORT PUBLIC SATISFACTION SURVEY - MEMBER CONSULTATION SURVEY**

The Committee received and considered a survey from Oxfordshire County Council.

RECOMMENDED: that the survey is circulated to all Town Councillors for response, subject to an extension being granted to the response closing date.

724 **UPDATE FROM OCC LOCALITIES COMMITTEE**

The Committee received and considered an update from Oxfordshire County Council’s Localities Committee.

RECOMMENDED: that the update be noted.

725 **ITEMS SUBMITTED TO THE TOWN CLERK**

a) Speeding in Bridge Street

Correspondence had been received from a resident concerning cars speeding in Bridge Street. The Chair asked if people were interested in undertaking a Community Speed watch. John Croxton commented that the police had to carry out speed enforcement on safety grounds and a community speed watch was a good way into this. The Community Policing Team would be able to advise on kit etc. Mr Croxton added that the police were prosecuting and educating more people than ever before on speeding issues but it was evidence led.

Members thought his was a good idea and something to be supported.

RECOMMENDED: that the Town Clerk speaks to the local police inspector about this and takes the information back to the Town Council. The resident who had written in should be thus advised.

b) New Pedestrian Crossing Request

A resident had written requesting a new pedestrian crossing on Deer Park Road. Members commented that it was imperative to get the message across with developers at an early stage.

RECOMMENDED: that the correspondence be noted.

c) Footpath/Baffle Barrier at Rear of Property in Colwell Drive

Members considered a report concerning a resident's complaint about a new baffle barrier being installed on a footpath at the rear of his house, which was now being used as a means of accessing his garden and ASB. The Chair advised that she had been directly involved in getting this installed as an elderly gentleman had been knocked over and badly injured on this footpath by school children bicycles.

RECOMMENDED: that the Chair speaks directly to the gentleman.

726 **CLIMATE EMERGENCY**

The Committee received and considered the minutes of the meeting of the Climate Emergency Working Party. Trevor Bayliss of Stagecoach advised that they were trying to reduce their carbon footprint by bringing in emission free buses. The first one in Witney would see service in October and by the end of the year there should be 21 in service.

Cllr Coles referred to the recent Car Free Day held in the town and the Chair added that it was definitely something that the Committee could play a role in next year.

It was agreed that the Climate Emergency should be a standing item on the Committee's agendas.

RECOMMENDED:

1. that the minutes be noted;
2. that the Climate Emergency be a standing item on the Committee and that the Committee supports Car Free Day next year;
3. that the Climate Working Party be advised to think how it would like to use the TAC.

727 **REPORT OF THE PRINCIPAL OFFICER - TRAFFIC SCHEMES AREA OPERATIONS (NORTH) - OXFORDSHIRE COUNTY COUNCIL**

The Committee received and considered the report of the Principal Officer – Traffic Schemes Area Operations (North). The Chair suggested that going forward the Committee has an item for future business and Officers could start to draw up a Forward Plan. She felt this might encourage WODC members to attend and also felt that someone from the Strategy side at OCC

should come to the next meeting. Mike Wasley advised that this would be Jackie Coles although she would probably delegate this downwards.

RECOMMENDED:

1. that the report be noted;
2. that a standing agenda item – Forward Plan – future business – be included on future agendas.

728 **ITEMS RAISED BY MEMBERS AT THE MEETING**

The Chair asked members to think about some substantive items that they might want to discuss in more detail via a Forward Plan, so this could be shaped with the Committee.

Cllr Ashbourne had recently attended a meeting in her capacity as a WODC Councillor which had discussed health in the district and one of the top three causes of death was road traffic accidents. It might be worth looking into – it could be speeding/dangerous driving. There had not been a breakdown of data but she would go back and ask for the information.

Cllr King raised an issue on behalf of the Parking Manager at WODC who was unable to attend the meeting due to illness. There had been a proposal by the shop owners in High Street to the District Council's Business Development Manager to increase the length of the parking along the side of the wall in high street from 30 mins to one hour. The Chair was frustrated that despite the comprehensive parking review, very little had actually changed and she was reluctant to see such a change in isolation. She felt that the 30-minute turn around was very important for blue badge holders in particular. The District would be launching a full consultation.

Trevor Bayliss advised that going forward Stagecoach would be looking to reduce the dwell time of buses specifically in rush hours – Bridge Street coming in from Oxford and going out. They were having to add in time to the timetable to cope with this when what should actually happen is to reduce the times. He would be keen to talk about this at future meetings.

Cllr Coles had had complaints about taxis parked with their engines running. He would like a representative to attend future meetings.

Cllr Coles asked Mike Wasley and John Croxton about the possibility of planting at Springfield Oval as the residents' association had been allocated some S106 money and they had wondered if they could plant around the oval to reduce traffic. Mike had no objection but it should be planted in connection with the tree team. John advised that the police would have no objection as long as it was safe. Andrew Lyon asked if speeding was the issue as he had had complaints about the Community Bus. Cllr Coles replied that this had nothing to do with the bus and was at an early stage.

Cllr King raised an issue about drivers doing U turns around roundabouts. Cllr Price said that perhaps the Committee could be look at roundabouts as part of the accident records etc. Most members didn't think it was a problem and John Croxton said it was not an offence.

RECOMMENDED: to respond to WODC on the parking issue and explain that the Committee has concerns about a consultation being opened up on this in isolation and the Committee would welcome an opportunity to discuss wider parking issues including off street sites.

729 **DATE OF NEXT MEETING**

The date of the next meeting would be 14 January 2020.

The meeting closed at: 4.10 pm

Chair

This page is intentionally left blank

ACTION PLAN

Minute no.	Issue	Action	Responsible person	Further Action	Date complete
T700	Problems with 'Baffle Barriers' for mobility scooters	Kevin Hickman has now submitted comprehensive review doc to WTC. Only one barrier was owned by WODC. None were WTC's. Others either private developers or OCC.	N/A	Leave on plan until budget identified by OCC, Committee needs to check accessibility f barrier against national standards. Ask Paul Fermer to get appropriate person to speak to Committee about getting them standardised.	
T700	Traffic concerns at the Ducklington Lane junction	Request for a left turn arrow into Thorney Leys.	Mike Wasley	Awaiting funding for modelling of junction. This was an item for the OCC strategy team.	
T700	Shores Green Junction	Initial long term funding identified. Design process to start summer 2019.	Mike Wasley		
T700	Marriots Walk Crossing – barriers/controlled crossing	Lighting complete, tree removal not required, agreed planters are not suitable barriers and awaiting relining by OCC	Mike Wasley	OCC to reline existing area, before removing block paving and resurfacing with blacktop.	
T700	Request for bus stop at Windrush Cemetery	OCC getting quotes for this.	Town Clerk/Trevor Bayliss/David Bellchamber/Mike Wasley	Quote received but OCC challenging them as they were too high. Mike Wasley to check with David Bellchamber re: footpath.	
T700	Request for yellow lines at Compton Way and Judds Close	Ongoing issue. County Councillors looking into funding for this.	Mike Wasley	Update at next meeting.	
T700	Renewal of white line markings across the town	Would start again in April. OCC would appreciate WTC input. Mike Wasley had circulated list as part of his report in June.	Mike Wasley/members of TAC via e-mail		

ACTION PLAN

T700	Parking at Highworth Place	This would be done.	Cllr Laura Price/Mike Wasley	This was now programmed in.	
T683	New Roundabout on A40	John Croxton commented that there have been a lot of accidents and signage incorrect. Mike Wasley said there was ongoing dialogue between OCC and the developers.	Mike Wasley/developers	John Croxton advised piercement signs and markings had now gone in. Further updates only if available.	
T701	Parking in Service Road at Welch Way	No TRO so could not be enforced. OCC to repaint Keep Clear on turning circle	Mike Wasley	Update on timescale.	

WITNEY TRAFFIC ADVISORY COMMITTEE **CONSTITUTION AND TERMS OF REFERENCE**

1. **Title**

- 1.1 The Committee shall be known as the “Witney Traffic Advisory Committee”, hereinafter called the “Advisory Committee”.

2. **Administration**

- 2.2 The administration of the Advisory Committee will normally be undertaken by the Town Clerk of Witney Town Council, or by his or her representative.

3. **Meetings of the Advisory Committee**

- 3.1 Meetings of the Advisory Committee will normally be held four times a year, commencing at 2.30pm, on dates set by Witney Town Council in consultation with Oxfordshire County Council.
- 3.2 The quorum of the Committee shall be five members.
- 3.3 No business other than that set out in the agenda published by the Town Clerk may be considered at a meeting of the Advisory Committee unless details have been notified to the Town Clerk prior to the start of the meeting, and the Chair has agreed to such matter being considered on the grounds of urgency.

4 **Chair**

- 4.1 The Chair shall be elected by the Advisory Committee at its annual meeting in September.
- 4.2 The Chair needs to be an elected member of one of the local authorities represented on the Advisory Committee.
- 4.3 In the event that the Chair is absent from a meeting of the Advisory Committee, a member of the Advisory Committee shall be elected to chair the meeting.

5 **Representatives**

- 5.1 The Advisory Committee may include representatives from the following who shall be regarded as members of the Advisory Committee: -

Representatives from:

- | | | |
|----|-----------------------------------|------------------------------------|
| a) | Witney Town Council | 3 – 4 |
| b) | West Oxfordshire District Council | 1 – 2 |
| c) | Oxfordshire County Council | 3 (+ Cabinet Member for Transport) |
| d) | Magistrates Committee | 1 – 2 |
| e) | Road Safety Committee | 1 – 2 |
| f) | Witney Chamber of Trade | 1 |
| g) | Thames Valley Police | 1 |

Other organisations which have been invited to send a representative: -

1999	CPRE	1
2003	Stagecoach	1
2004	Freight Transport Association	1
	Local Driving Instructors	1
	Local Taxis	1
2009	Witney BUG	1
2019	Witney Community Transport	1

5.2 Any other organisation represented on the Advisory Committee may, at the discretion of the Advisory Committee, have more than one representative.

6. **Officers**

6.1 Officers representing (a) the County Council's Director of Environment and Economy; (b) the District Council's Strategic Director (Development) and Strategic Director (Environment); and (c) Thames Valley Police shall have a right to attend meetings of the Advisory Committee and speak in an advisory capacity.

7. **Terms of Reference**

7.1 The Advisory Committee does not have executive powers, but may consider any traffic related matter of concern either directly or indirectly to the Parish of Witney, and may offer advice on such matters to Oxfordshire County Council, West Oxfordshire District Council, Witney Town Council, or to any other relevant organisation as may be appropriate.

7.2 The following list is not exhaustive but is the type of matters which may be discussed by the Advisory Committee: -

- a) Existing or proposed road systems or traffic management schemes
- b) One way systems
- c) Traffic calming
- d) Waiting restrictions
- e) Traffic signalling, signing and road markings
- f) Pedestrian crossings and school crossings
- g) Footpaths
- h) Street Lighting
- i) On-street and off-street car parking
- j) Road safety engineering

8. **Public Participation**

8.1 Meetings of the Advisory Committee shall be open to the public and press, other than in exceptional circumstances, where the public and press may be excluded by resolution of the Advisory Committee on the grounds of the confidential nature of the business to be transacted.

8.2 At the discretion of the Chairman, Members of the public or representatives of organisations may address the Advisory Committee. The address shall be in the form of a statement lasting

not more than five minutes. The person giving the address shall not be permitted to participate in any subsequent debate by the Advisory Committee on the matter in question.

9. **Amendments to constitution and Terms of Reference**

- 9.1 The Advisory Committee's constitution and terms of reference may be amended at any time by resolution of the Advisory Committee.

This page is intentionally left blank

Agenda Item 6

WITNEY TRAFFIC ADVISORY COMMITTEE – 14 JANUARY 2020 A415 Ducklington Lane

Consultation

RE: CONSULTATION – A415 Ducklington Lane (Witney) - Proposed 30mph Speed Limit extension and Prohibition of Vehicles

We are writing to seek your views on the proposal to extend the 30mph speed limit, south on the A415 Ducklington Lane and introduce a “No Right Turn” prohibition (i.e. only left turns permitted) for traffic entering on the east side of the A415 Ducklington Lane, from the new development just south of the A40 overbridge. This is a traffic safety measure associated with the new development. In light of this, please find the following consultation documents attached:

- Public Notice,
- Statement of Reasons,
- Consultation Plans,
- Draft Traffic Regulation Orders.

The proposed Traffic Regulation Order is scheduled to be advertised in the Witney Gazette today; Wednesday 27 November 2019. Details are also available to view on the Councils consultation pages at the address below:

<https://consultations.oxfordshire.gov.uk/consult.ti/Witney30mphNRT/consultationHome>

As stated on the notice, any objections or other representations on the proposal should be submitted by **Friday 31 December 2019**.

Kind Regards

Jane

Jane Clark
Officer (Traffic & Road Safety)
Area Operations Hub
Communities|Oxfordshire County Council |County Hall|New Road|Oxford|OX1 1ND

This page is intentionally left blank

OXFORDSHIRE COUNTY COUNCIL
1. (WITNEY AREA) (SPEED LIMITS) ORDER 20**
2. (WITNEY, DUCKLINGTON LANE) (PROHIBITION OF
RIGHT TURN) ORDER 20**

NOTICE IS HEREBY GIVEN that Oxfordshire County Council proposes to make the above orders under the Road Traffic Regulation Act 1984 and all other enabling powers. The effect of the orders, in response to local development and for road safety reasons is as follows:

- 1) To extend the 30mph speed limit on Ducklington Lane southwards to near Ducklington roundabout in place of the current 40mph; and
 - 2) To make a prohibition of right turn onto Ducklington Lane from the proposed development on the east side of the A415 south of the A40 overbridge, ensuring that exiting vehicles turn left only to the roundabout.
- The Oxfordshire County Council (Witney Area) (Speed Limits) Order 2018 will be revoked/replaced.

A copy of the proposed orders and all detailed documents may be inspected online by visiting: <https://consultations.oxfordshire.gov.uk>, or in person at County Hall, New Road, Oxford, OX1 1ND between 9am and 4.30pm Monday to Friday; and at WODC Town Centre Shop, 3 Welch Way, Witney, OX28 6JH, from 9am to 5.30pm Monday to Thursday, and 9am to 5pm on Fridays.

Objections to the proposals, specifying the grounds on which they are made and any other representations, may be sent in writing to the address below (or via the web address above) no later than **31 December 2019**. The Council will consider objections and representations received in response to this Notice. They may be disseminated widely for these purposes and made available to the public.

Traffic Regulation Team (Ref: JaC.12.6.410) for the Director of Community Operations, County Hall, Oxfordshire County Council, New Road, Oxford, OX1 1ND.

This page is intentionally left blank



OXFORDSHIRE COUNTY COUNCIL

- OXFORDSHIRE COUNTY COUNCIL**
1. (WITNEY AREA) (SPEED LIMITS) ORDER 20**
**2. (WITNEY, DUCKLINGTON LANE) (PROHIBITION OF
RIGHT TURN) ORDER 20****

STATEMENT OF REASONS

As a result of the development of land adjacent to the A415 Ducklington Lane, south of Witney, the County Council is proposing, for road safety reasons, to extend the 30mph limit on the Ducklington Lane, southwards, by approximately 27 metres, reducing the existing 40mph speed limit by the same amount.

It is also proposed to introduce a “No Right Turn” prohibition (i.e. only left turns permitted) for traffic entering the A415 Ducklington Lane, from the site exit road.

The Oxfordshire County Council (Witney area) (Speed Limits) Order 2018 will be revoked / replaced as required.

The County Council continues its responsibility to consider the provision of convenient and safe movement of motor vehicles and other traffic, and the proposed measure is aimed at ensuring that ¹ danger is minimised whilst ² facilitating the effective and safe passage of traffic.

Detailed documents accompany this form.

Date: 27th November 2019

Traffic Regulation Team, for the
Director for Infrastructure Delivery,
Oxfordshire County Council,
County Hall
New Road,
Oxford
OX1 1ND.

¹ Section 1 (1) (a) Road Traffic Regulation Act 1984

² Section 1 (1) (c) Road Traffic Regulation Act 1984

This page is intentionally left blank

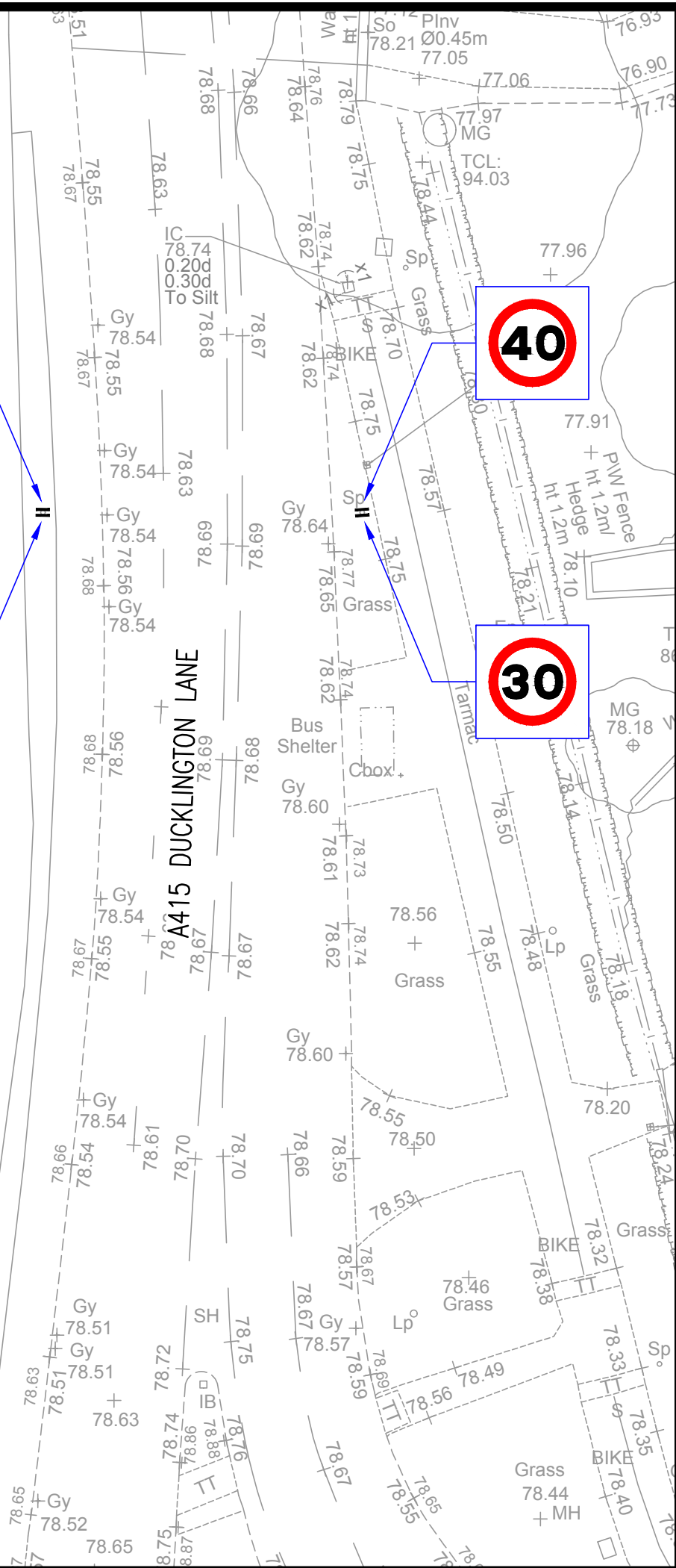
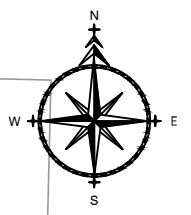

30MPH ZONE EXTENDED 27.2m SOUTH

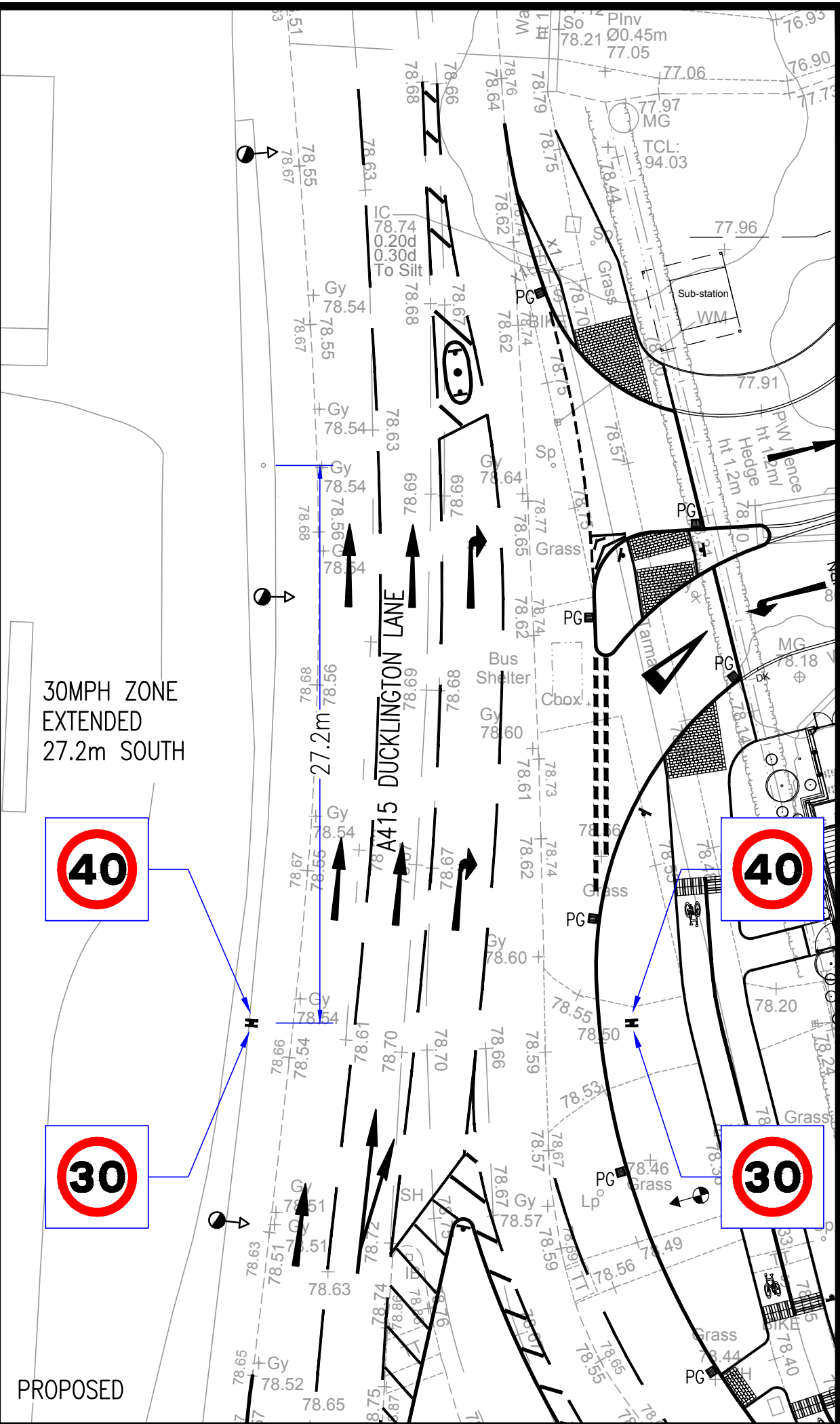

- © Copyright ADL Traffic & Highways Engineering Ltd
NOTES
1. Do not scale from this drawing
 2. All details to be confirmed on site.
 3. Background plan is based upon a topographical survey supplied by greenhatch group and architects site plan supplied by DDP.
Drawing No. 191 - 100 Rev. A.

Rev	Description	Date	By	Chk

AMENDMENTS



ADL Traffic & Highways Engineering Ltd.
ADL House
The Oaklands Business Park
Yate, Bristol
BS37 5NA
Tel : 01454 332100
Fax : 01454 327983
E-Mail : hcad@adlhighways.co.uk

ADL Job No. **4353**

Project: **A415 Ducklington Lane
Witney**

Title: **TRO Plan
Extension of 30mph zone**

Date: **17.10.19** Drawn: **MT**

Checked	Date	Approved	Date

Scale: **1:250@A3** Drg No. **4353-300** Rev. **-**

This page is intentionally left blank

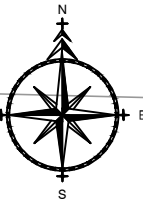

PROHIBIT RIGHT TURNS FROM SITE EGRESS. VEHICULAR TRAFFIC MUST TURN AHEAD IN THE DIRECTION INDICATED BY THE ARROW.

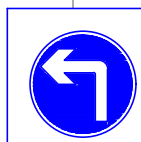

- © Copyright ADL Traffic & Highways Engineering Ltd
NOTES
1. Do not scale from this drawing
 2. All details to be confirmed on site.
 3. Background plan is based upon a topographical survey supplied by greenhatch group and architects site plan supplied by DDP.
Drawing No. 191 - 100 Rev. A.

Rev	Description	Date	By	Chk

AMENDMENTS



ADL Traffic & Highways Engineering Ltd.
ADL House
The Oaklands Business Park
Yate, Bristol
BS37 5NA
Tel : 01454 332100
Fax : 01454 327983
E-Mail : hcad@adlhighways.co.uk

ADL Job No. **4353**

Project **A415 Ducklington Lane
Witney**

Title **TRO Plan
Prohibit right turns**

Date **17.10.19** Drawn **MT**

Checked	Date	Approved	Date

Scale	Org No.	Rev.
1:250@A3	4353-301	-

This page is intentionally left blank

**OXFORDSHIRE COUNTY COUNCIL
(WITNEY, DUCKLINGTON LANE)
(PROHIBITION OF RIGHT TURN) ORDER 20****

Oxfordshire County Council (“the Council”) in exercise of its powers under Sections 1(1), 2(1) & (2) of the Road Traffic Regulation Act 1984 (“the Act”) and of all other enabling powers, and after consultation with the Chief Officer of Police in accordance with Part III of Schedule 9 to the Act hereby make the following Order.

This Order may be cited as the Oxfordshire County Council (Witney, Ducklington Lane) (Prohibition of Right Turn) Order 20** and shall come into force on the day of 20**.

1. Save as provided by article 2 of this Order no person shall, other than under the direction of a police constable in uniform, cause or permit a vehicle to make a right turn northwards onto the A415 Ducklington Lane from (*site to be named later*) land on the east side of said road between Ducklington roundabout and the A40 overbridge (“the Section of Road”).

2. Nothing in article 1 to this Order shall render it unlawful for a person to cause or permit a vehicle to enter the Section of Road northwards if the vehicle is being used for Police, fire or ambulance services in an emergency;

GIVEN UNDER the Common Seal of the Oxfordshire County Council
this day of 20**.

THE COMMON SEAL of **THE**
OXFORDSHIRE COUNTY COUNCIL
was affixed in the presence of:

Director of Law & Governance / Designated Officer

This page is intentionally left blank

**OXFORDSHIRE COUNTY COUNCIL
(WITNEY AREA) (SPEED LIMITS) ORDER 20****

The Oxfordshire County Council, in exercise of its powers under Section 84 and Part IV of Schedule 9 to the Road Traffic Regulation Act 1984 (“the Act”) and of all other enabling powers, and after consultation with the chief officer of police in accordance with Part III of Schedule 9 to the Act, hereby make the following Order.

1. This Order may be cited as the Oxfordshire County Council (Witney Area) (Speed Limits) Order 20** and shall come into force on the day of 20**.
2. No person shall drive any motor vehicle at a speed exceeding 30 miles per hour in any of the lengths of road specified in Schedule 1 to this Order.
3. No person shall drive any motor vehicle at a speed exceeding 40 miles per hour in any of the lengths of road specified in Schedule 2 to this Order.
4. No person shall drive any motor vehicle at a speed exceeding 50 miles per hour in any of the lengths of road specified in Schedule 3 to this Order.
5. No speed limit imposed by this Order applies to a vehicle falling within Regulation 3(4) of the Road Traffic Exemptions (Special Forces) (Variation and Amendment) Regulations 2011, being a vehicle used for naval, military or air force purposes, when used in accordance with regulation 3(5) of those regulations.
6. The Oxfordshire County Council (Oxfordshire County Council (Witney Area) (Speed Limits) Order 2018 is hereby revoked.

GIVEN UNDER the Common Seal of the Oxfordshire County Council
this day of 20**.

SCHEDULE 1

30mph speed limit:

The whole length of every road in Witney (except those roads and sections of road listed in Schedule 2) extending, in the case of the respective roads leading out of the town, to the following points:

a)	A4095 Curbridge Road	125 metres southwest of its junction with Deer Park Road
b)	B4047 Burford Road	55 metres west of its junction with Tower Hill
c)	Crawley Road.	222 metres northwest of its junction with Quarry Road
d)	Hailey Road	222 metres northwest of its junction with Eastfield Road (partly in the parish of Hailey)

e)	New Yatt Road	182 metres northeast of its junction with Early Road	
f)	Oxford Hill	50 metres southeast of its junction with Cogges Hill Road	
g)	Stanton Harcourt Road	30 metres south of its junction with Manor Road	
h)	Woodstock Road A4095	288 metres northeast of its junction with Harvest Way	
i)	Ducklington Lane, A415	A point 315 30 metres north of its junction with Ducklington roundabout	
j)	Thorney Leys	to a point 89 metres west of its junction with Ducklington Lane.	
and			
k)	Downs Road	from its junction with the B4047 Burford Road, southwards	for a distance of 1040 metres.

SCHEDULE 2

40mph speed limit:

1.	Book Ends	for its entire length.	
2.	B4047 Burford Road	from a point 55 metres west of its junction with Tower Hill, westwards	to a point 411 metres west of its junction with Downs Road - partly in the Parish of Curbridge.
3.	Deer Park Road	for its entire length.	
4.	A415 Ducklington Lane	from a point 30 metres north of the Ducklington roundabout 315 metres south of its junction with Station Lane, southwards.	for a distance of 226 199 metres , partly in the Parish of Ducklington
5.	Range Road	for its entire length.	
6.	Thorney Leys	from a point 540 metres southeast of its junction with the A4095 Curbridge Road, eastwards	to a point 89 metres southwest of its junction with Ducklington Lane.
7.	A4095 Witney to Woodstock road	from a point 50 metres southwest of its junction with Park Road, North Leigh, north-eastwards	to a point 380 metres northeast of its junction with Park Road, North Leigh.

8.	A4095 Curbridge Road	from a point 125 metres southwest of its junction with Deer Park Road, south-westwards	for a distance of 250 metres.
9.	Downs Road	from a point 1040 metres south of its junction with the B4047 Burford Road, southwards	to its junction with Main Road (partly in the parish of Curbridge)
10.	Downs Road / A40 Link Roads	from their roundabout junction with Downs Road (including its circulatory lanes), south-eastwards	to its roundabout junction with the A40

SCHEDULE 3

50mph speed limit:

The A4095 Witney to Woodstock road within the Parishes of Witney and North Leigh:		
A4095 Witney Road	a) from a point 288 metres northeast of its junction with Harvest Way, Witney (the terminal point of the existing 30mph limit), north-eastwards	to a point 50 metres southwest of its junction with Park Road, North Leigh
	b) from a point 380 metres northeast of its junction with Park Road, North Leigh, north-eastwards	to a point 117 metres northeast of its junction with Cuckoo Lane, North Leigh (the terminal point of the existing 40mph speed limit) a distance of approximately 4150 metres.
Jubilee Way, Witney	from its junction with Woodstock Road, Witney, southwards	to its junction with Oxford Hill, Witney, approximately 1650 metres.

The A40 Witney Bypass in the Parish of Witney:		
A40 dual carriageway	from a point 326 metres west of the centre of Downs Road overbridge, eastwards (including the roundabout circulatory lanes)	to a point 489 metres east of the centre of Downs Road overbridge.

**THE COMMON SEAL of THE
OXFORDSHIRE COUNTY COUNCIL**

was hereunto affixed in the presence of:

Director of Law & Governance / Designated Officer

This page is intentionally left blank

DRAFT - CONFIDENTIAL

**Witney Burford and Carterton Locality Meeting
18th October 2019, Mount House, Witney
Draft Minutes**

Note	Action
<p>In Attendance</p> <p>Cllrs Handley and Field-Johnson Lucy Butler (CEDR), John Courouble (Notes), Paul Wilson, Jacqui Cox, Barbara Chillman, Elena Grant</p>	
<p>1 Apologies for Absence</p> <p>Cllrs Bartington, Price, Fenton</p>	
<p>2 Minutes of previous meeting</p> <p>Agreed</p> <p>Matters arising other than where covered on agenda</p> <ul style="list-style-type: none"> • Continuing issues around Wildlife Park access, accidents and congestion • Parish pleased with 30mph speed limit changes • John has written to police regarding PSPO and CCTV • Discussions needed about mitigation work for housing in Eynsham and North Oxford and impact on A40 • Follow up bus partnership question 	
<p>3 Election of Military Champion</p> <p>Cllr Handley had expressed interest in continuing in this role. Cllr Field-Johnson seconded this and is happy to deputise when needed</p> <p>Cllr Handley elected John to check date of military covenant event <i>[Done and circulated]</i></p>	John C
<p>4 a) Highways Area Operations Update</p> <p>Paul presented updated information on officers covering the area Supply contact details for relevant local officers</p> <p>Discussion around how Councillors can follow up “stuck” pieces of work e.g. situation around Carterton underpass Information circulated around winter service</p> <p>Get Carterton on the Council’s market town map</p>	John C/Paul W

DRAFT - CONFIDENTIAL

<p>Salt bins in villages. Highways have asked for towns and parishes to request, council has written to them. We do not refill or check all 1300 by default.</p>	
<p>If letter not received Paul can resend. Nick to talk to Asthall clerk</p>	Nick/Paul W
<p>Discussion around resurfacing, minor patching, dragon, and marking up together with longer term micro asphalt programme – Launton Avenue to be included.</p>	Paul W
<p>Need for work around entrance to waterworks Shilton – ford has gone all over the road again, coming up the drain onto the road. Could be fixed with kerbstones and lift.</p>	Paul W
<p>PW to meet with Cllr Handley on site to discuss further</p>	Pete/PW
<p>White lines reported as done which have not in fact been done? Paul to continue to raise with safety/Traffic team – wildlife park to Lechlade would benefit from double white lines in areas where overtaking is causing accidents. Winter period not ideal for lining.</p>	Paul W
<p>Paul to check situation re Grafton</p>	Paul W
<p>John Rawlins – Paul to ask for tree cutting schedule particularly re Burford – Update – Work has started on epicormic growth this week; will address all roads in question whilst contractors are on site</p>	
<p>b) Infrastructure Planning Update</p>	
<p>Arising from previous minutes</p>	Jacqui C
<ul style="list-style-type: none">- Wildlife Park, meet to discuss scheme and potential sources of funding. Moving payment from car entrance to pedestrian entrance after parking should help? Involve Cllrs Handley and Field-Johnson in meeting.- Minster Lovell slip road from Carterton heading West. Awaiting feedback on draft report from WODC, which will clarify need for improvements. To add case based on planned housing developments and military expansion including freight. Relationship with military important here.	Jacqui C
<p>c) TAC minutes for information</p>	
<p>Received with thanks. To discuss achievements of WOCT and future plans.</p>	Laura / John C
	Paul W / Jacqui C

To discuss what would be required for Carterton to establish a TAC.	
---	--

This page is intentionally left blank

Ling-tang Cottage, New Vatt Road, North Leigh, Witney, OX29 6TJ

7/01/20

Nicky Cayley

Democratic Services Officer

Witney Town Council

Dear Nicky

I spoke to you before Christmas about the chaos in Welch Way and you said that it could be put on the Agenda for the Traffic Management meeting on January 14th.

I enclose a list of the problems.

Yours sincerely

Diana Power

PROBLEMS ASSOCIATED WITH WELCH WAY AND THE CULDE SAC

VEHICLES (CUL DE SAC)

Vehicles parking on the pavement outside Costa including drivers going to Costa, Greggs, the shops on Welch Way, Marriots Walk, Rowlands Pharmacy, the Library and delivery drivers going to all of the previous plus the Health Centre.

Enormous lorries delivering to the backs of shops on the High Street and to Clarks Timber. Open Reach vans going to and fro from their centre.

Cars going to and fro to the paying car park at the back of Lloyds Bank (who owns this ?)

There are not enough disabled car park spaces for the Health Centre users and there is not enough space for patients to unload wheel chairs etc. safely. They face danger every time they leave their cars.

Frustrated drivers accelerate dangerously once an obstruction has moved.

Drivers turning into the cul de sac are forced to stop because of traffic jams. This creates a build up back to the High Street and also obstructs view of the pedestrian crossing

WELCH WAY

Enormous lorries using the backs of Marriots Walk shops and the apartments (including waste lorries) .

Cars and lorries parked on double yellow lines outside Greggs and the other shops.

Emergency vehicles -Police, Fire and Ambulance, often on a rapid response with sirens wailing have difficulty in driving.

Traffic turning into and out of the cul de sac face obstructions not only of vehicles but also of people who seem oblivious of any danger.

PEOPLE

People stream across the pedestrian crossing and also the mouth of the narrow cul de sac without looking and often on their phones. There are many parents with pushchairs and toddlers on scooters and also elderly people with wheel chairs, scooters and strollers using this busy street (there was an accident by the pedestrian crossing before Christmas).

People use the cul de sac as a short cut between the High Street and Marriots Walk (and vice versa) and use the road rather than the pavement, crossing obliquely behind the disabled cars with total disregard of their safety.

Students use the back way from the college as a short cut, again with disregard of their safety.

The pedestrian crossing is too close to the entrance of Marriots Walk so that people step straight on to it without pausing. The bus stop is too close to the crossing and obscures the crossing.

CONCLUSION

In concluding, it is an absolute mess and very DANGEROUS, it needs a genius to sort it out. Welch Way was designed a long time ago and traffic and footfall has increased. Witney needs Marriots Walk and its free car parking but safety of its people is paramount.

This page is intentionally left blank